

Soil compactor axles

Vehicle weight tons	Rear axle model	Gearbox option
From 1.5 to 4	28.16 R	TB172 Hydrostatic single speed
From 5 to 8	28.25 R	TB172 Hydrostatic single speed
From 9 to 11	28.32 R	TB172 Hydrostatic single speed
From 12 to 15	28.48 R	TB172 Hydrostatic single speed Input planetary drive
From 16 to 19	28.60 R	TB172 Hydrostatic single speed Input planetary drive
From 20 to 25	28.80 R	TB172 Hydrostatic single speed Input planetary drive

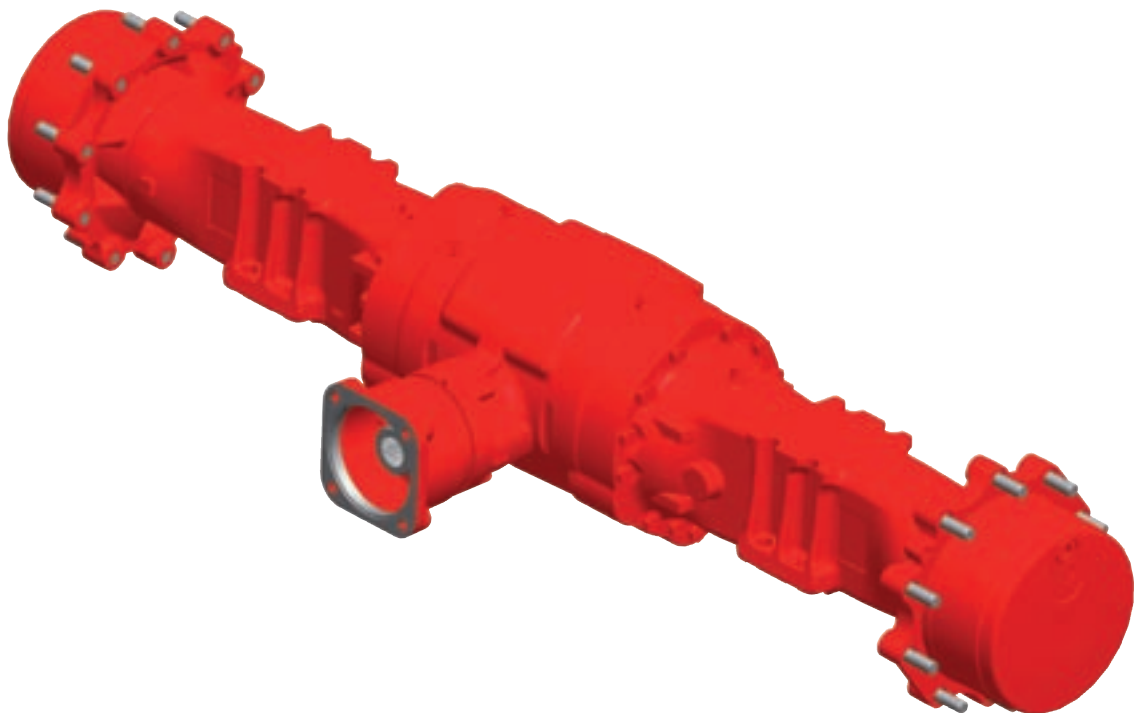

MODEL		28.16 R	28.25 R	28.32 R
Overall width	mm	1,260	1,512	1,860
Flange to flange distance	mm	1,100	1,270	1,654
Wheel mounting dimension		n° 8 M18x1.5 on 275 mm ø	n° 8 M18x1.5 on 275 mm ø	n° 10 M22x1.5 on 335 mm ø
Total reduction		From 30 to 110	From 40 to 110	From 40 to 110
Peak torque	kNm	22.5	35	45
Dynamic load capacity	kN	50	80	90
Static load capacity	kN	125	200	225

MODEL		28.48 R	28.60 R	28.80 R
Overall width	mm	1,988	1,928	2,040
Flange to flange distance	mm	1,700	1,640	1,740
Wheel mounting dimension		n° 10 M20x1.5 on 335 mm ø	n° 10 M20x1.5 on 335 mm ø	n° 12 M22x1.5 on 425 mm ø
Total reduction		From 43 to 110	From 43 to 110	From 43 to 110
Peak torque	kNm	67.2	84	112
Dynamic load capacity	kN	90	110	120
Static load capacity	kN	225	275	300

Note

For soil compactors Carraro also offers a full range of hydrostatic drives for the front drum.