

Model TR1883 is a high reduction ratio, heavy duty split shaft PTO is designed to allow the main engine to both propel the truck to the work site and then shift to PTO mode to power auxiliary deck equipment such as pumps, blowers, drills etc. The gearbox mounts between the trucks transmission and the rear axle. Power is directed to the rear axle or to the PTO shaft, but not to both at the same time. An anti-kick out feature Insures that it will not "walk" out of either the PTO mode or the driving mode as long as torque is applied to the input shaft.

The gears are constant mesh with a sliding clutch used to select PTO or drive modes. The gears are helical, carburized, and precision ground for high strength and quiet operation. The case is cast iron and the bearings tapered roller throughout

<b>Nominal HP:</b>	750
<b>Max input speed:</b>	2800
<b>Center distance :</b>	13.7 inches
<b>Ratio input to output:</b>	2.914, 1.957, 2.703 to 1
<b>Shift :</b>	Air or mechanical cable
<b>Lubrication:</b>	Pump/splash
<b>Input shaft:</b>	2.75 X 10
<b>Output shaft:</b>	2.75 X 10
<b>Weight:</b>	800 lbs.
<b>Options:</b>	Flanges, pump pad, shafts.
<b>Comments or application notes:</b>	High reduction heavy duty unit used primarily for driving piston pumps.

# MODEL TR1883 TRANSFER CASE

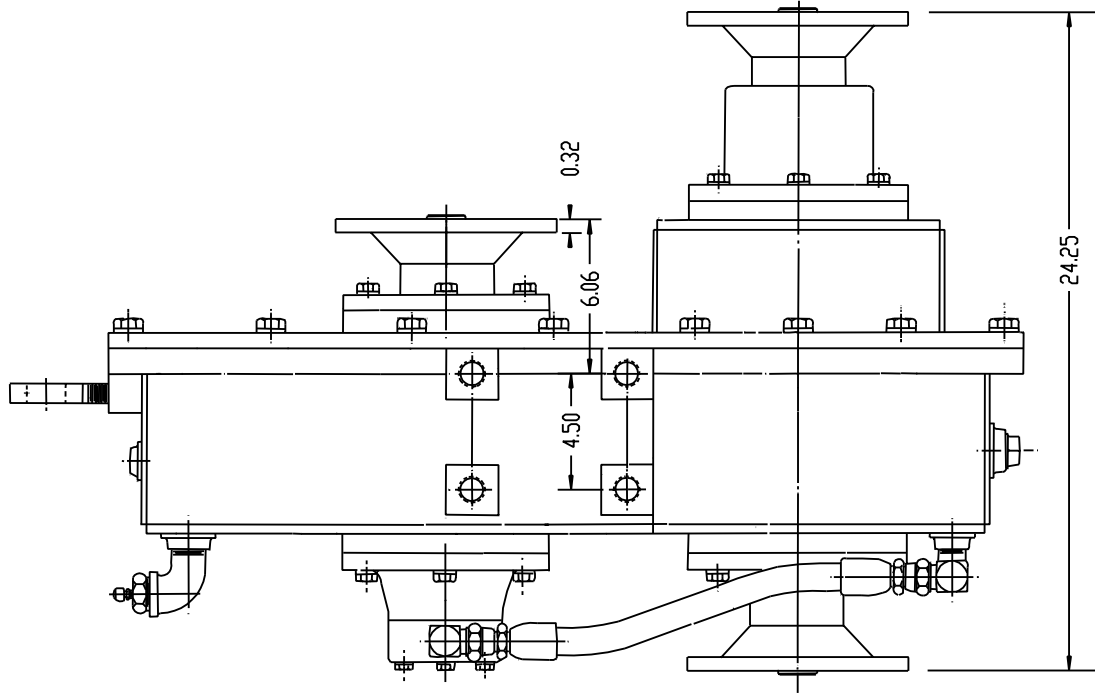
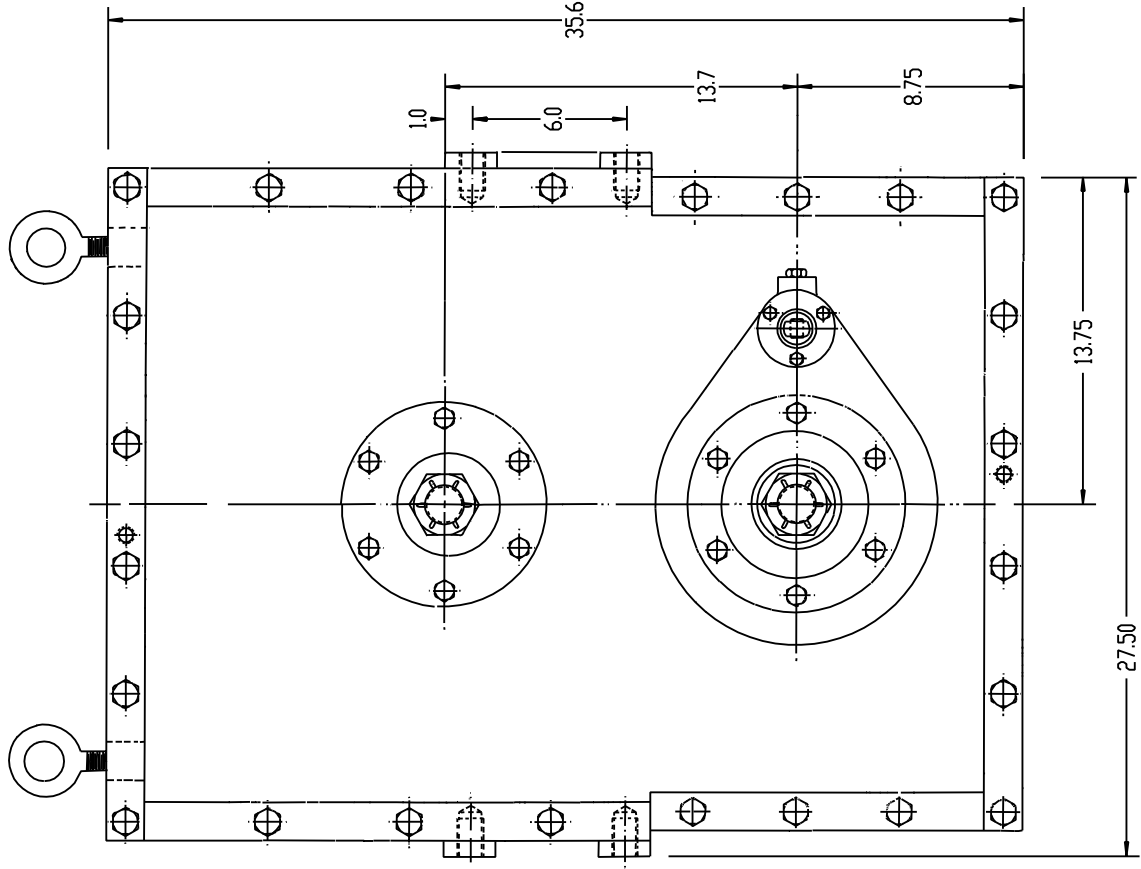

DO NOT USE DIMENSIONS ON THIS DRAWING FOR  
INSTALLATIONS. USE CERTIFIED PRINT PROVIDED  
WITH ORDERS.